



MH12

ASSEMBLY | DISPENSING | MACHINE TENDING
MATERIAL HANDLING | PACKAGING

KEY BENEFITS

Versatile design applicable to multitude of applications.

Contoured arm design to improve access and reduce peripheral interferences.

Hollow-arm design for ease of cable management and enhanced cable life.

SPECIFICATIONS

12 kg payload

1,440 mm horizontal reach

2,511 mm vertical reach

±0.08 mm repeatability

CONTROLLERS



DX200



FS100



MLX200

- Powerful high-speed six axis robot is ideal for multitude of applications.
- 12 kg wrist payload and additional mounting surface on upper arm (up to 10 kg), enables ease of integration of complex gripper tools without compromising performance.
- Enhanced robot work space features 1,440 mm horizontal reach and 2,511 mm vertical reach. The large work envelope extends behind the robot, allowing space for robot tool storage or maintenance.
- Hollow upper arm provides optimal cable protection while enhancing operational reliability. A 50 mm through-hole in the wrist encloses the cable and protects it from wear, interference or snagging.
- New, contoured arm design reduces interference with fixtures, parts or machinery.
- Patented double yoke upper arm design provides additional strength to protect the arm in case of undesired crashes.
- Symmetric wrist profile provides consistent motion and clearances regardless of robot approach.
- Floor-mounted model is standard. A wall-mounted version is available. Brakes are included on all axes.
- The MH12 has an IP67-rated wrist and an IP54 body standard. An XP (eXtra Protection) package that increases the body protection rating to IP65 is available.
- An anti-corrosive paint option is available for environments where harsh acidic or alkaline cleaners are used, such as food processing facilities.
- Ideally suited for use in high-density work cells with multiple robots working in close proximity.

MH12 ROBOT

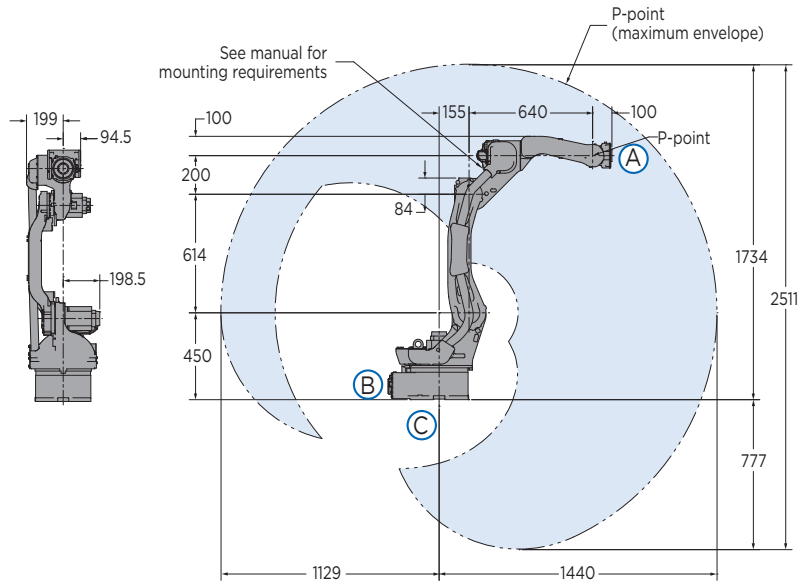

VIEW A

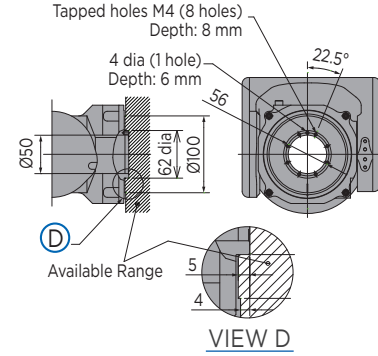

VIEW B

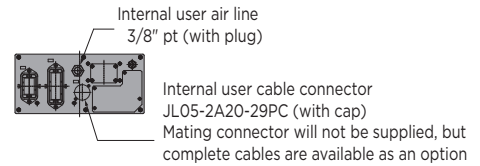

VIEW C

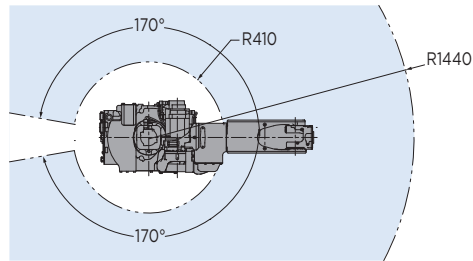
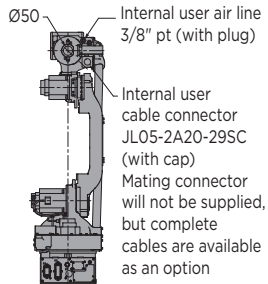
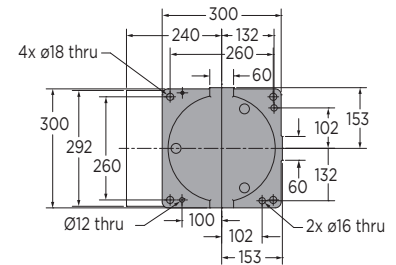

All dimensions are metric (mm) and for reference only.
Request detailed drawings for all design/engineering requirements.

SPECIFICATIONS

Axes	Maximum motion range [°]	Maximum speed [°/sec.]	Allowable moment [N•m]	Allowable moment of inertia [kg•m ²]	Controlled axes	
S	±170	220	-	-	Maximum payload [kg]	6
L	+155/-90	200	-	-	Repeatability [mm]	12
U	+240/-175	220	-	-	Horizontal reach [mm]	±0.08
R	±180	410	22	0.65	Vertical reach [mm]	1,440
B	±135	410	22	0.65	Weight [kg]	2,511
T	±360	610	9.8	0.17	Internal user I/O cable (+ ground)	130
					Internal user air line	17 conductors
						(1) 3/8" connection

OPTIONS

- Extended length manipulator cables
- Robot risers and base plates
- Wide variety of fieldbus cards
- MotoSight™ 2D and 3D vision systems
- Robot base and upper arm I/O cables

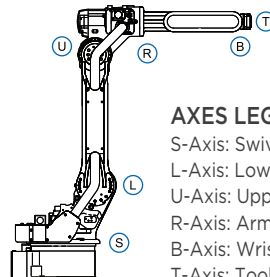

AXES LEGEND

- S-Axis: Swivel Base
- L-Axis: Lower Arm
- U-Axis: Upper Arm
- R-Axis: Arm Roll
- B-Axis: Wrist Bend
- T-Axis: Tool Flange

Yaskawa America, Inc.
Motoman Robotics Division

100 Automation Way
Miamisburg, OH 45342
Tel: 937.847.6200
Fax: 937.847.6277

motoman.com



MOTOMAN ROBOTICS